

BLOCK OF THE MONTH – (JANUARY AND) FEBRUARY

Note: There is no block of the month drawing scheduled for the January meeting.

LINEAR CURVES

"A Wrinkle in Time" – *Book title by Madeleine L'Engle.*
Is time linear, or curved? If linear, it takes all the time in the world to get from now to then. But, if it's curved, a person can step across the curve, and go from one winter to the next the time it takes to tell it.

Are curves round, or are they straight? If round, then there's a class for learning to do that. If straight, then it's the block of the month. **Here's a way to get the visual effect of a curve, using only straight piecing.** This is a basic log cabin construction, with half the 'logs' being half the width of the others. I have found paper piecing the most precise method for this. For those who prefer, here are regular piecing instructions as well. I suggest making two blocks, reversing the two fabrics in the second block. Block samples are posted at Back Porch Fabrics and Hand Maden in Pacific Grove.

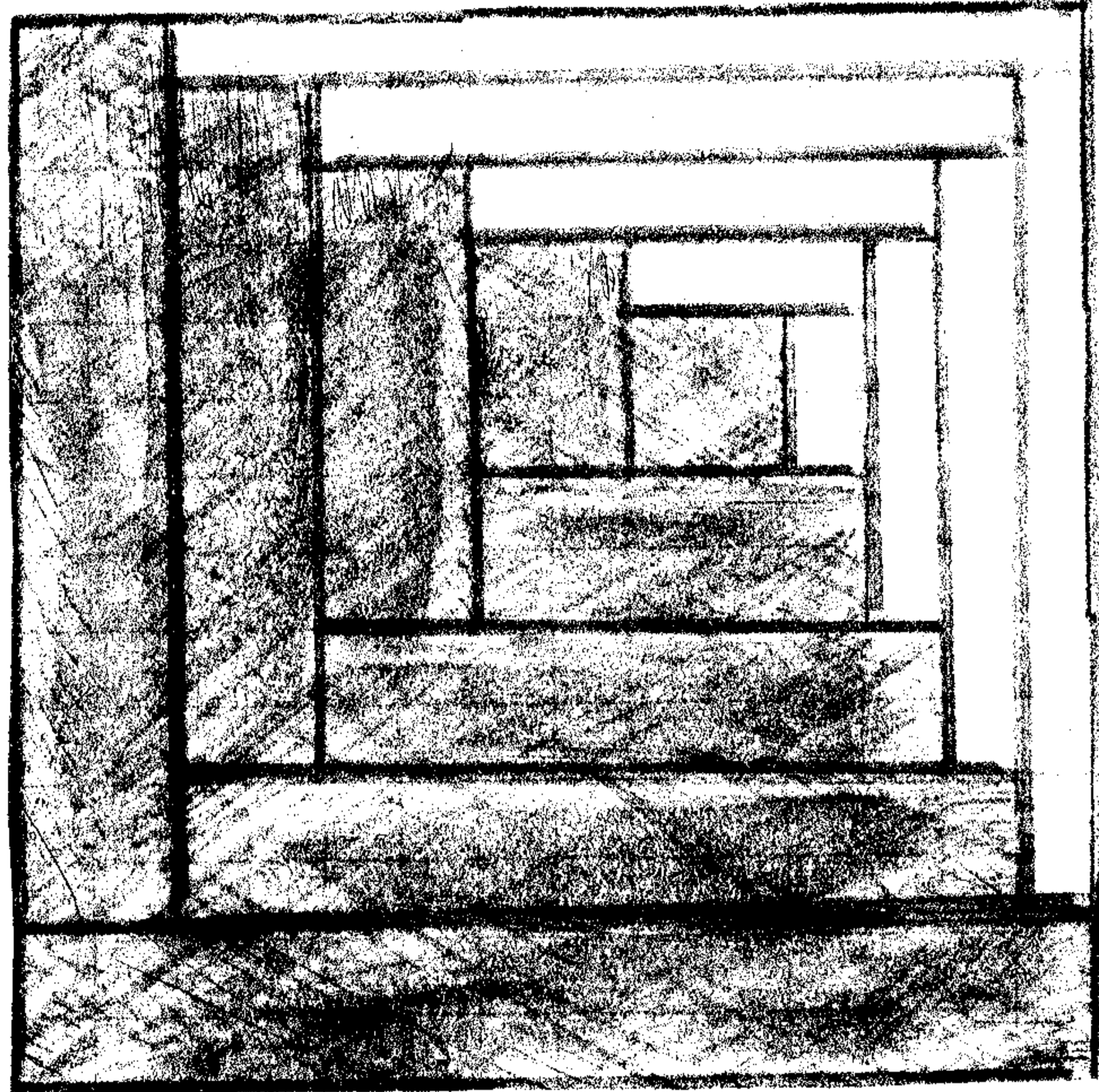

Block size: 7.5", including seam allowance

Fabric: two batiks, designated as A for the center and wide logs, and B for the narrow logs.

PAPER PIECING

Copy or print out the paper piecing pattern for as many blocks as you want to make. Remember that the placement of narrow and wide logs is reversed on the pattern, so that the finished block will be the same as the picture. When paper piecing logs, I cut long fabric strips ahead of time, a quarter or a half inch wider than for straight piecing. - PATTERN NEXT PAGE -

STRAIGHT PIECING

- Cut from Fabric A:

One strip 1.5" wide by 42" long. Cut this strip into the following 9 lengths:

Center block: 1.5" sq.; A1: 2"; A2: 3"; A3: 3.5"; A4: 4.5"; A5: 5"; A6: 6"; A7: 6.5"; A8: 7.5"

- Cut from Fabric B:

One strip 1" wide by 36" long. Cut this strip into the following 8 lengths:

B1: 1.5"; B2: 2"; B3: 3"; B4: 3.5"; B5: 4.5"; B6: 5"; B7: 6"; B8: 6.5"

Assemble following the diagram. To the right side of the center square, add B1. Press seam toward B1. Add B2 to the top of Center+B1; press seam toward B2. Add A1 to to the left side of Center+B1+B2. Press toward A1. Add A2 to bottom of Center+Ba+B2+A1. Press toward A2. Continue adding logs in the same pattern until you have a center plus four logs on each side. Note: because of the small measurements, use a scant quarter inch seam allowance. If needed, make the last two logs a little extra wide, so the block reaches a full 7.5" square.

Any questions or comments? Call Ann-Lining Smith+ 831/662-1804

